

Anchor Bolt Kit

Model 24999

The Anchor Bolt Kit is a unique security device to prevent the theft of unauthorized movement of any type of office equipment. It can also be used to secure equipment to prevent unexpected movement during an earthquake or aboard a moving vehicle.

- Impact resistant die-cast metal anchor bolt can be attached to any solid surface
- Can be used to secure any type of equipment
- Fast-setting adhesive provides over 5,000 lbs. of bonding strength
- Easy installation

Materials

Anchor Bolt: Die-cast zinc with chrome plate finish

Adapter Foot: 12 gauge steel with neoprene coating

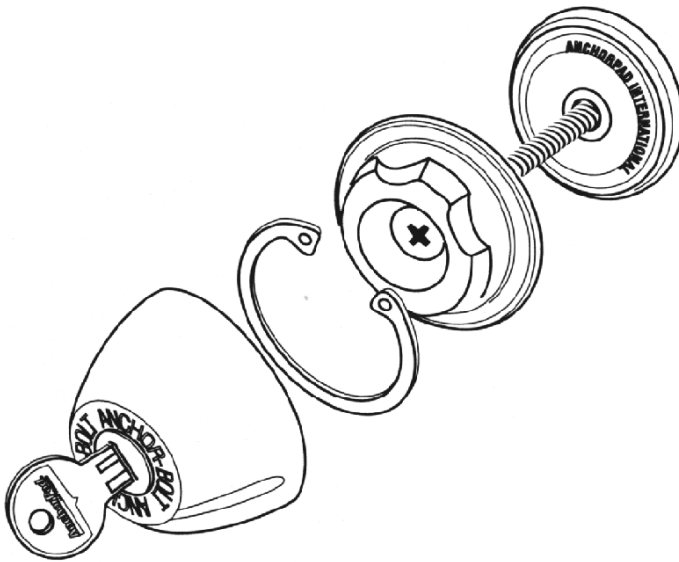

Model Includes

- One (1) Anchor Bolt
- One (1) adapter foot
- One (1) 1/4-20 screw
- One (1) wafer lock with two (2) keys
- One (1) bonding glue
- One (1) cleaning packet
- Installation instructions

Easy Three-Step Installation

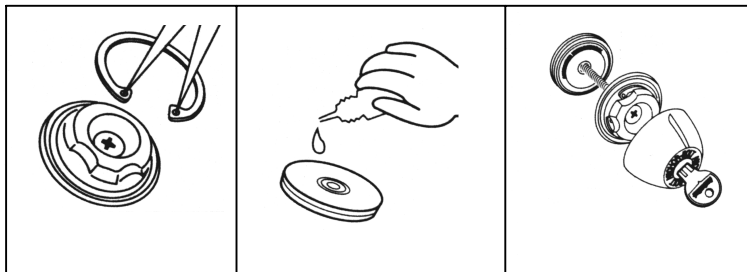

1 Assemble Anchor Bolt using retaining ring pliers. Drill 5/16" diameter hole in desired location.

Note: Retaining ring pliers not included.

2 Clean attachment location and adapter foot using alcohol cleaning pad. Apply 9 drops of glue in a circular pattern to the adapter foot. Attach to desired location and hold in place for thirty seconds.

3 Put screw through drilled hole and thread into adapter foot. Thread lock into Anchor Bolt and remove key.
Note: A different length screw may be required. (not included)

CEKA-AnchorPad

V.Rydsvägen 105 196 31 Kungsängen
Tel 08-581 653 50 Fax 08-581 736 01
www.anchorpad.se info@anchorpad.se